

Coffs Harbour campus map

- **A Block**
Head of Campus; Campus Security; general teaching spaces; education teaching rooms; student computer labs;
- **B Block**
General learning spaces
- **C Block**
SCU College; general learning spaces
- **D Block**
Lecture theatre D.150 and D.350
- **E Block**
General learning spaces
- **F Block**
Student Health & Support Services; Career Development Service; Coffs Harbour Students' Association; cafeteria; University Lounge; coffee shop; EFTPOS facility
- **Gathering Space**
Outdoor common area adjacent to the D block lecture theatre and food outlets
- **SCU Village**
Accommodation services; Carina College
- * Other buildings
- P **Parking**
- B **Bus stop**
- **H Block**
Nursing anatomy laboratory
- **I Block**
Osprey Restaurant
- **IC**
Coffs Harbour Innovation Centre
- **L Block**
Multi-purpose centre
- **O Block**
Lecture theatre; general learning spaces
- **Q Block**
Nurse education – clinical nursing; laboratories
- **T Block**
Teaching Gym / Coffs Harbour Gym
- **U Block**
Health Sciences Building – health laboratories
- **Southern Cross University – M Block**
Student Administration Services; Shared Services Hub; Academic Skills Development; University Advocacy Support; IASS (Indigenous Australian Student Services); AIME (Australian Indigenous Mentoring Experience); Southern Cross Postgraduate Association; midwifery lab; sport and exercise science lab; psychology labs; School of Arts and Social Sciences; School of Business and Tourism; School of Education; School of Health and Human Sciences; SCU International; Equity and Diversity; Chaplaincy

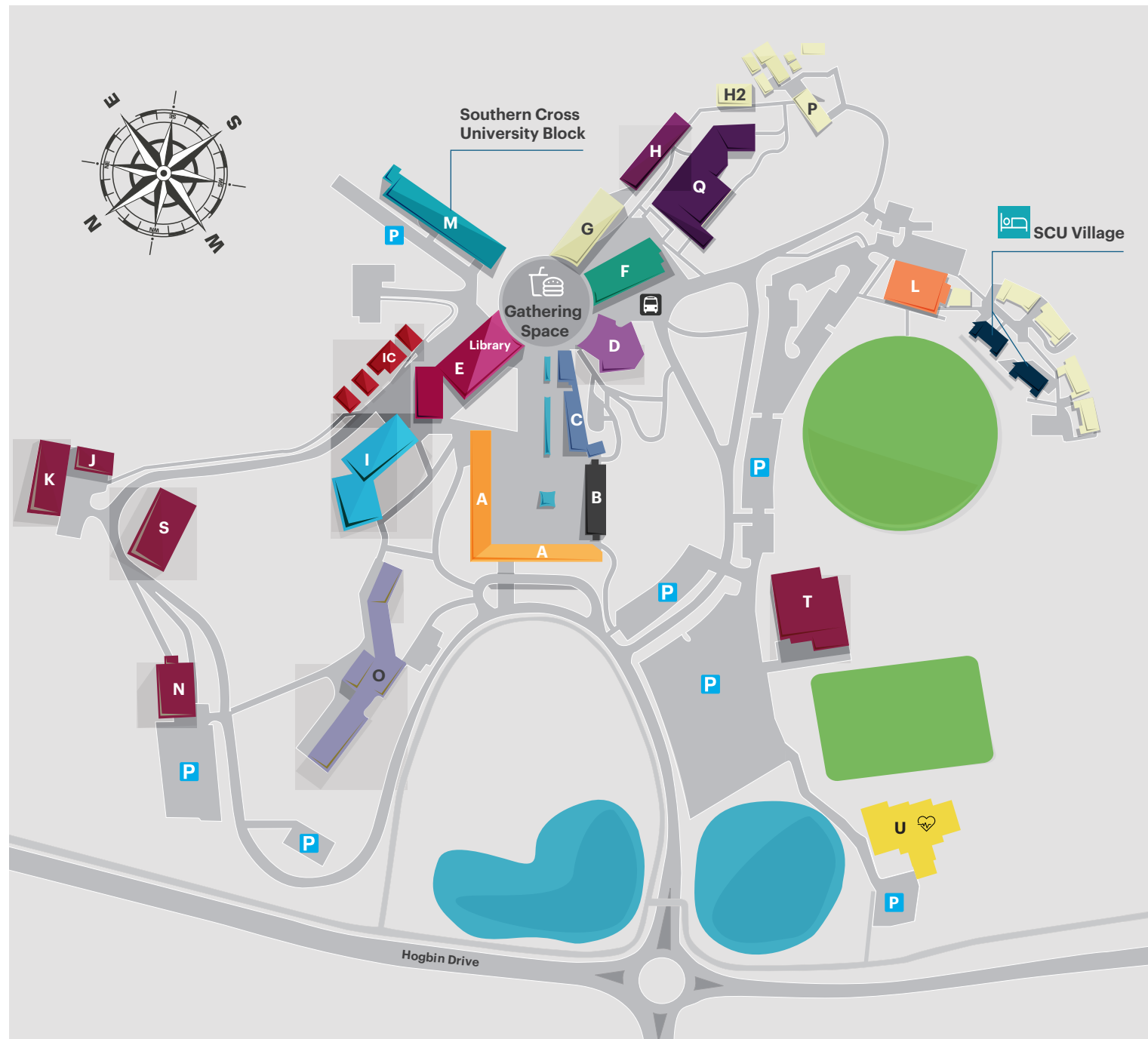

Note: The room numbering format at the Coffs Harbour campus is: Block / Floor / Room Number. For example A.G.9 is A Block, Ground Floor, Room 9.